



Pallet Feet & Fittings **SQUARE**



1410

Thickness: **2.3**
Weight (Kg/100): **25**
Post size(mm): **40**
Load testing average
per ft (Tonne): **2.46**

PALLET FOOT 89MM SQUARE X
2.3 mm THICK

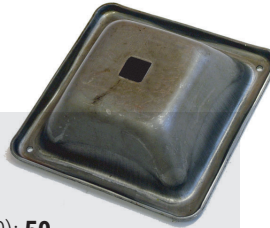
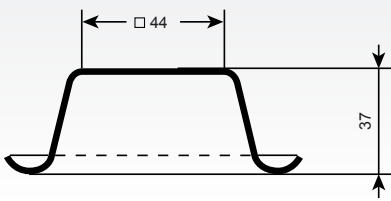

0138

Thickness: **2.3**
Weight (Kg/100): **50**
Post size(mm): **50**
Load testing average
per ft (Tonne): **2.19**

PALLET FOOT 127MM SQUARE X
2.3 mm THICK

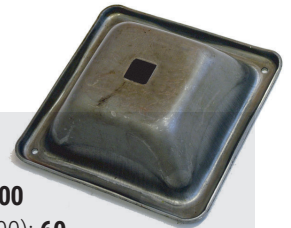
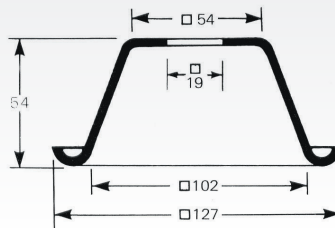

0100

Thickness: **3.00**
Weight (Kg/100): **60**
Post size(mm): **50**
Load testing average
per ft (Tonne): **4.36**

PALLET FOOT 127MM SQUARE X
3.0 mm THICK

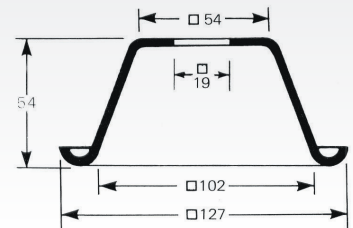

0104

Thickness: **3.2**
Weight (Kg/100): **60**
Post size(mm): **50**
Load testing average
per ft (Tonne): **4.78**

PALLET FOOT 127 SQ X 3.2MM
THICK

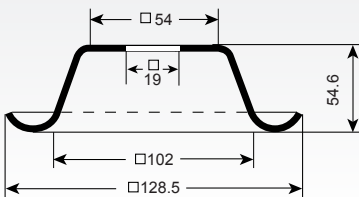

0139

Thickness: **2.3**
Weight (Kg/100): **50**
Post size(mm): **60**
Load testing average
per ft (Tonne): **6.29**

PALLET FOOT 127 SQ X 2.3 mm
THICK- 64MM TOP

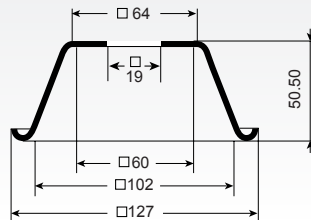

0101

Thickness: **3.0**
Weight (Kg/100): **60**
Post size(mm): **60**
Load testing average
per ft (Tonne): **8.27**

PALLET FOOT 127 SQ X 3.0 mm
THICK- 64MM TOP

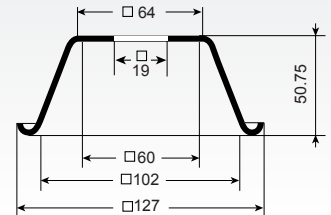

All measurements in mm

0143

Thickness: **3.2**
 Weight (Kg/100): **64**
 Post size(mm): **60**

PALLET FOOT 127 SQ X 3.2MM THICK-66MM TOP

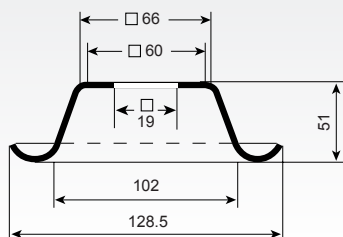

0140

Thickness: **3.0**
 Weight (Kg/100): **98**
 Post size(mm): **70**
 Load testing average per ft (Tonne): **4.58**

PALLET FOOT 165MM SQUARE X 3.0 mm THICK

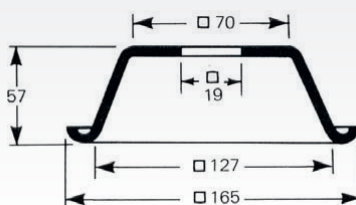

0140S

Thickness: **3.0**
 Weight (Kg/100): **100**
 Post size(mm): **70**

PALLET FOOT 165 SQ X 3.0MM - STAINLESS STEEL

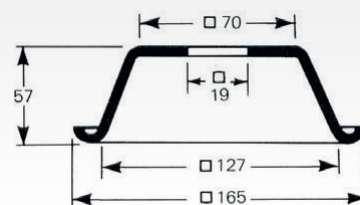
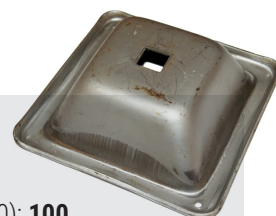

0142

Thickness: **4.5**
 Weight (Kg/100): **68**
 Post size(mm): **50**
 Load testing average per ft (Tonne): **7.28**

TOYOTA PALLET FOOT (F66) 100MM SQUARE

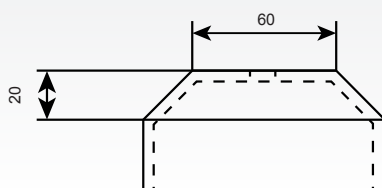

0141

Thickness: **3.0**
 Weight (Kg/100): **12**
 Post size(mm): **50**

TOYOTA TOP CAP FOR 50MM SQ RHS

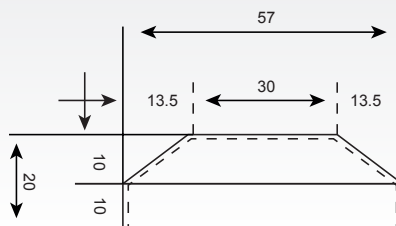

0102

Thickness: **6.0**
 Weight (Kg/100): **150**
 Post size(mm): **60**
 Load testing average per ft (Tonne): **18.25**

PALLET FOOT 130MM SQUARE X 6.0 mm THICK

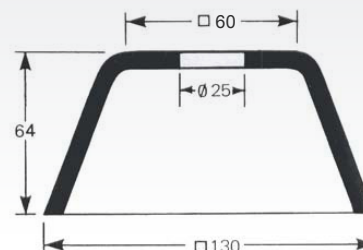



0105

Thickness: **5.0**

Weight (Kg/100): **125**

Post size(mm): **80**

Load testing average
per ft (Tonne): **15.99**

PALLET FOOT 152MM SQUARE X
5.0 mm THICK

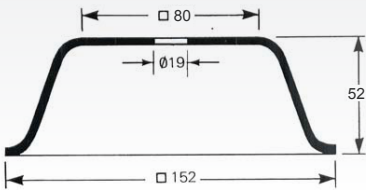

All measurements in mm



Pallet Feet & Fittings **ROUND**



0107

Thickness: **3.0**
Weight (Kg/100): **49**
Post size(mm): **70**

ROUND PALLET FOOT 130mm DIA
X 3.0 mm THICK

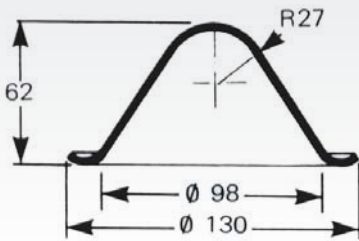

0118

Thickness: **3.0**
Weight (Kg/100): **41**
Post size(mm): **70**

ROUND PALLET FOOT 130mm DIA
X 3.0 mm THICK

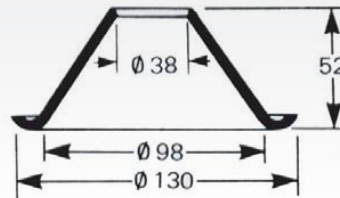

0113

Thickness: **3.0**
Weight (Kg/100): **32**
Post size(mm): **60**

ROUND PALLET FOOT 97mm DIA
X 3.0 mm THICK

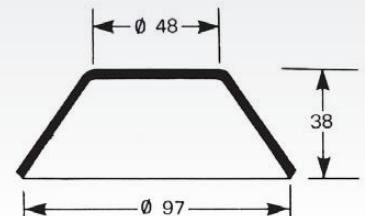

0113S

Thickness: **3.0**
Weight (Kg/100): **33**
Post size(mm): **60**

ROUND PALLET FOOT 97 DIA X
3.0mm THICK 55 - STAINLESS
STEEL

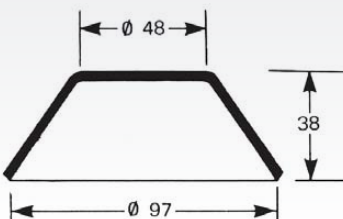

0114

Thickness: **1.6**
Weight (Kg/100): **7**
Post size(mm): **25**

ROUND PALLET FOOT 64MM DIA
X 1.6MM THICK

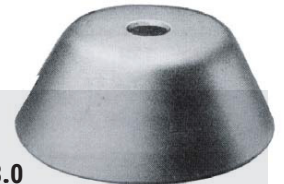
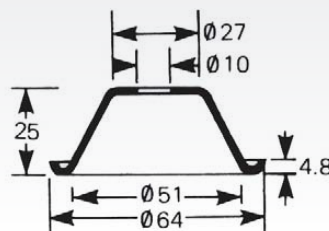

0124

Thickness: **3.0**
Weight (Kg/100): **31**
Post size(mm): **60**

ROUND PALLET FOOT 129mm DIA
X 3.0 mm THICK

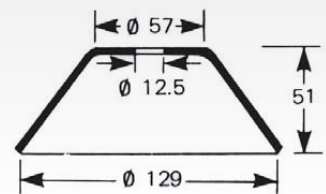

All measurements in mm



Pallet Feet & Fittings **ROUND**



0131

Thickness: **1.6**
Weight (Kg/100): **6**
Post size(mm): **70**

ROUND PALLET FOOT 64mm DIA
X 1.6 mm THICK

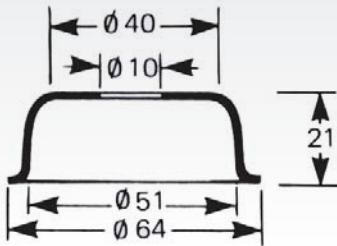

0125

Thickness: **3.0**
Weight (Kg/100): **31**
Post size(mm): **60**

ROUND PALLET FOOT 103mm DIA
X 3.0 mm THICK S.S.

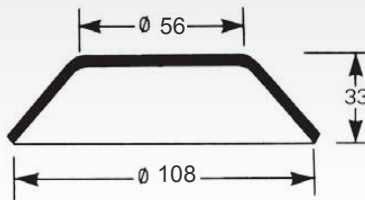

0125S

Thickness: **3.0**
Weight (Kg/100): **31**
Post size(mm): **60**

ROUND PALLET FOOT 103mm
DIA X 3.0 mm THICK - STAINLESS
STEEL

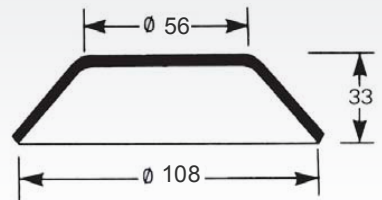

0145

Thickness: **2.5**
Weight (Kg/100): **33**
Post size(mm): **60**

PATT 0145 - 60mm FLAT - 2.5mm
PALLET FOOT - 110mm BASE

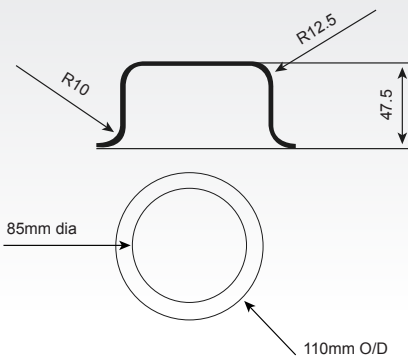

All measurements in mm

Birmingham Stopper

T: 0121 551 7781 F: 0121 554 4567 E: info@birminghamstopper.co.uk W: www.birminghamstopper.co.uk
Icknield Street, Hockley, Birmingham B18 6QU



Pallet Feet & Fittings
NESTING PLUGS



0116

Thickness: **3.0**

Weight (Kg/100): **13**

Post size(mm): **50**

THREE SIDED NESTING PLUG
50MM x 54MM

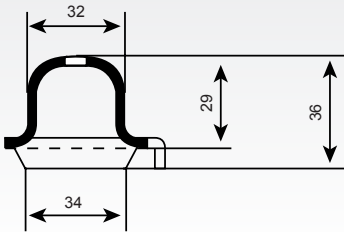

0117

Thickness: **3.0**

Weight (Kg/100): **13**

Post size(mm): **50**

FOUR SIDED NESTING PLUG
50MM SQ

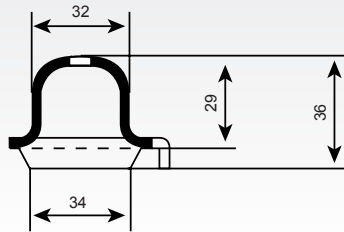

All measurements in mm



Pallet Feet & Fittings **TWO SIDED PALLET FEET**

0110

Thickness: **3.0**
Weight (Kg/100): **16**
Post size(mm): **40**



TWO SIDED PALLET FOOT 70mm -
3mm THICK

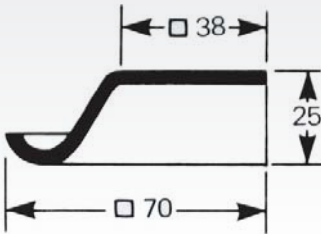

1546

Thickness: **5.0**
Weight (Kg/100): **36**



TWO SIDED PALLET FOOT 82mm -
4.8mm THICK

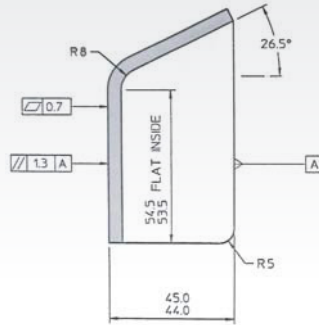

BS22

Thickness: **5.0**
Weight (Kg/100): **45**
Post size(mm): **70**

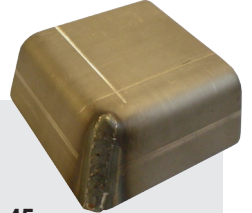

PALLET FOOT TWO SIDED 90mm
5.00mm MS

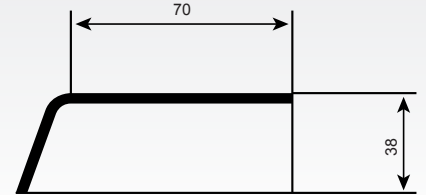

BS60

Thickness: **4.0**
Weight (Kg/100): **62**
Post size(mm): **50**

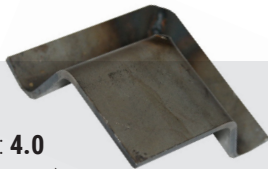

PALLET FOOT TWO SIDED 108MM
4.00MM MS

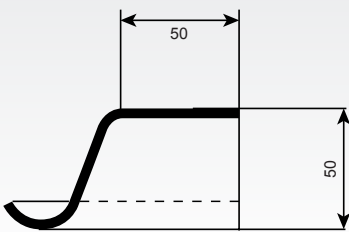

BS72

Thickness: **4.0**
Post size(mm): **60**

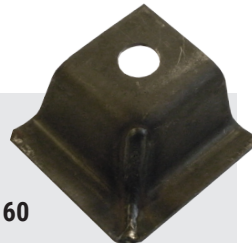

PALLET FOOT TWO SIDED 108MM
4.00MM MS

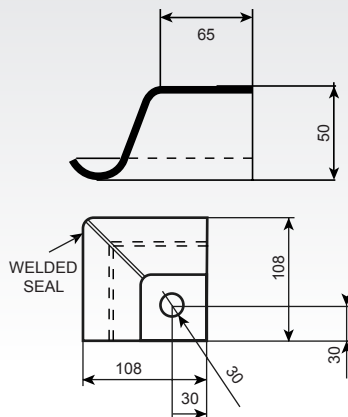

All measurements in mm



Pallet Feet & Fittings

PALLET FURNITURE/ FITTINGS

111(A)

Thickness: **4.5**
Weight (Kg/100): **16**

111(B)

Thickness: **4.5**
Weight (Kg/100): **11**

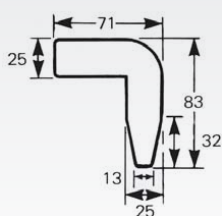
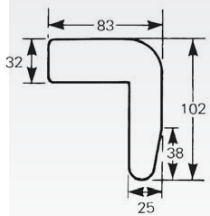

111(C)

Thickness: **4.5**
Weight (Kg/100): **10**

111(D)

Thickness: **4.5**
Weight (Kg/100): **8**

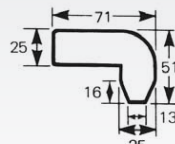
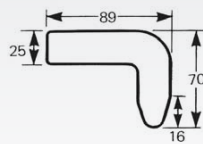

0112

Thickness: **3.0**
Weight (Kg/100): **4**
Staple

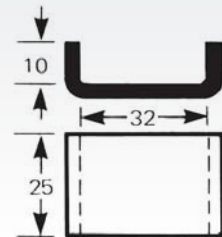

B2

Thickness: **3.0**
Weight (Kg/100): **4**
Staple

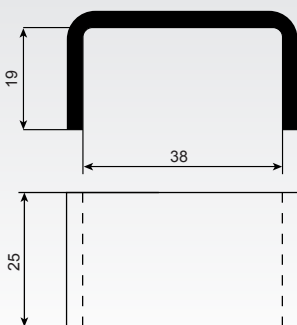

B11

Thickness: **3.0**
Weight (Kg/100): **7.5**
Staple

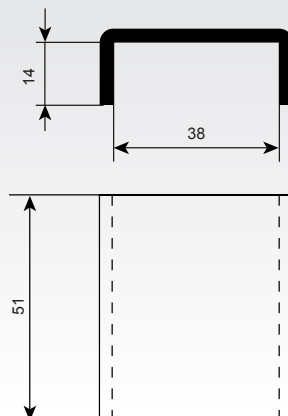

B5

Thickness: **3.0**
Weight (Kg/100): **3.5**
Staple

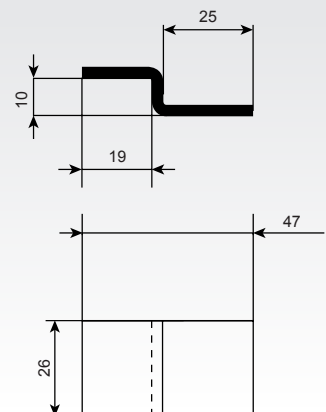
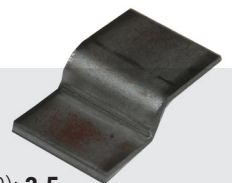

All measurements in mm



Pallet Feet & Fittings
POST CAPS

0549

Thickness: **1.6**

Weight (Kg/100): **6**

POST CAP 51.6MM - 1.6MM
THICK

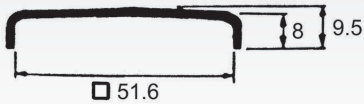

0141

Thickness: **3.0**

Weight (Kg/100): **12**

Post size(mm): **50**

TOYOTA TOP CAP FOR 50MM SQ
RHS

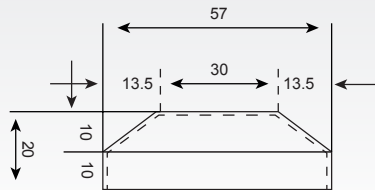

All measurements in mm



Pallet Feet & Fittings

SPRING & SHOOT BOLTS

0839/001

BASE RETAINING
ZINC PLATED

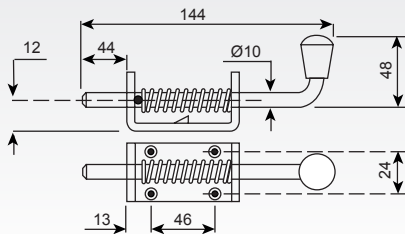

0840/001

BASE RETAINING
ZINC PLATED

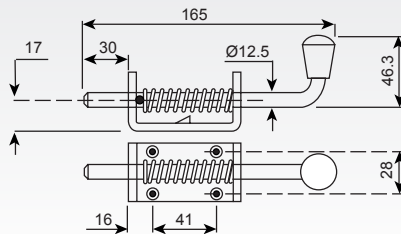

0840/002

BASE RETAINING
ZINC PLATED

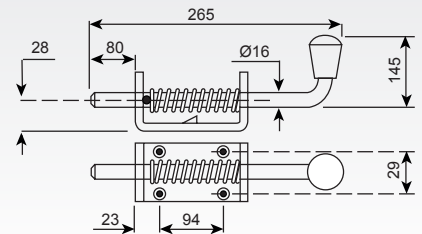

0841/001

BASE RETAINING
ZINC PLATED

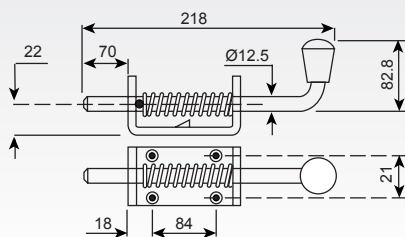

0836/001

BASE RETAINING WITH BASE TO
WELD ON.
ZINC PLATED BALL WITH A SELF
COLOUR BRACKET

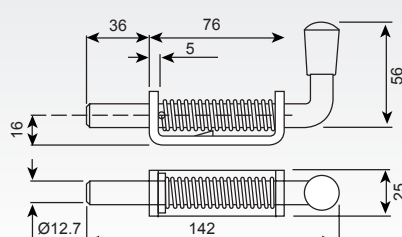

0838/001

TWIST LEVER OPERATION.
ZINC PLATED BALL WITH A SELF
COLOUR BRACKET
SELF COLOUR STEEL BODY WITH
A ZINC PLATED LEVER

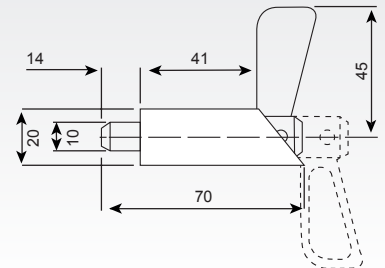

All measurements in mm